

Product designation	Rotary cam switches		
Product type designation	7GN63		
General characteristics			
Switching diagram	25 - 1-phase motor reversing switch with spring return		
N° of elements	2		
Mounting form	O - Rear mounting with black handle		
Contact characteristics			
Rated insulation voltage Ui	IEC/EN UL/CSA	V V	690 600
Rated impulse withstand voltage Uimp		kV	6
Conventional free air thermal current Ith	IEC/EN UL/CSA	A A	63 60
Rated operational voltage		V	480
Rated operational impulse voltage		kV	4
Maximum fuse size for short-circuit protection In (gG)	10kA 15kA 25kA 50kA 63kA	A A A A A	63 63 63 63 63
Rated short time current Icw	1s	kA	1600
Conductivity	10/5 mA/V		
Operational current Ie IEC/EN			
AC1/AC21A		A	63
AC15	110V 220/230V 380/400V 660/690V	A A A A	32 25 15 4
Rated operational power in AC			
Three-phase AC-3	220/230V 380/440V 500/690V	kW kW kW	11 18.5 18.5
Single-phase AC-3	110V 220/230V 380/440V	kW kW kW	3.7 6.5 11.5
Three-phase AC23A	220/230V 380/440V 500/690V	kW kW kW	12.5 30 30
Single-phase AC23A			

		110V	kW	3.7
		220/230V	kW	7.5
		380/440V	kW	12.5
Rated operational current in DC				
DC21A				
		48V	A	63
		60V	A	50
		110V	A	8
		220V	A	1
DC23A (poles in series)				
		24V	A	50 (1)
		48V	A	50 (2)
		60V	A	50 (3)
		110V	A	25 (3)
		220V	A	15 (4)
DC13				
		24V	A	63
		48V	A	40
		60V	A	28
		110V	A	3.3
Power dissipation			W	3.4
Mechanical features				
Terminals screw				M5
Tightening torque for terminals max			Nm	2
Conductor size				
AWG - Rigid cable				
	min	AWG		14
	Max	AWG		6
AWG - Flexible cable				
	min	AWG		14
	Max	AWG		8
Conductor size (IEC) - Flexible cable				
	min	mm <sup>2</sup>		2.5
	Max	mm <sup>2</sup>		10
Conductor size (IEC) - Rigid cable				
	min	mm <sup>2</sup>		2.5
	Max	mm <sup>2</sup>		16
Mechanical life			cycles	5x10 <sup>6</sup>
UL technical data				
Motor power for direct-on-line control				
for three-phase motor				
		120V	HP	7.5
		240V	HP	15
		480V	HP	25
		600V	HP	25
for single-phase motor				
		120V	HP	3
		240V	HP	10
Ambient conditions				
Temperature				
Operating temperature				
	min	°C		-25
	max	°C		+55
Storage temperature				

min °C -40  
max °C +70

### Resistance & Protection

Frontal IP degree	IP40
Terminals IP degree	IP00

### Dimensions

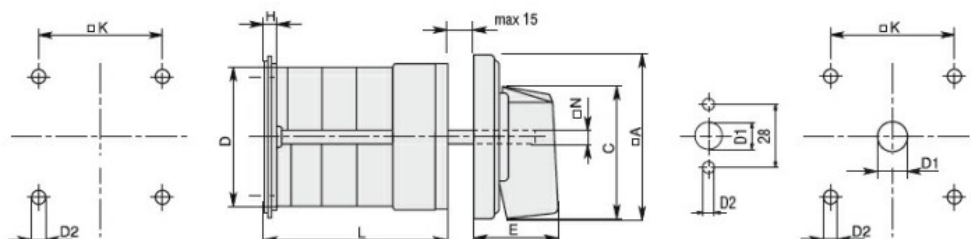

Series	Dimensions								L Number of elements											
	ØA	C	ØD	ØD2	E	H	ØK	ØN	1	2	3	4	5	6	7	8	9	10	11	12
7GN12	48	39.5	39	5	26.5	5	36	6	38.1	47.8	57.5	67.2	76.9	86.6	96.3	106	115.7	125.4	135.1	144.8
7GN20	48	39.5	39	5	26.5	5	36	6	38.1	47.8	57.5	67.2	76.9	86.6	96.3	106	115.7	125.4	135.1	144.8
7GN25	48	39.5	43	5	26.5	5	36	6	42.5	56.1	69.7	83.3	96.9	110.5	124.1	137.7	151.3	164.9	178.5	192.1
7GN32	65	53	58	5	34.5	5.5	48	7	48.5	63.6	78.7	93.8	108.9	124	139.1	154.2	169.3	184.4	199.5	214.6
7GN40	65	53	58	5	34.5	5.5	48	7	48.5	63.6	78.7	93.8	108.9	124	139.1	154.2	169.3	184.4	199.5	214.6
7GN63	65	53	62	6	34.5	7.5	68	7	53.3	71.4	89.5	107.6	125.7	143.8	161.9	180	198.1	216.2	234.3	252.4
7GN125	90	70.5	86	6	41.4	7.5	68	9	74.8	103.9	133	162.1	191.2	220.3	249.4	278.5	307.6	336.7	365.8	394.9

### Wiring diagrams

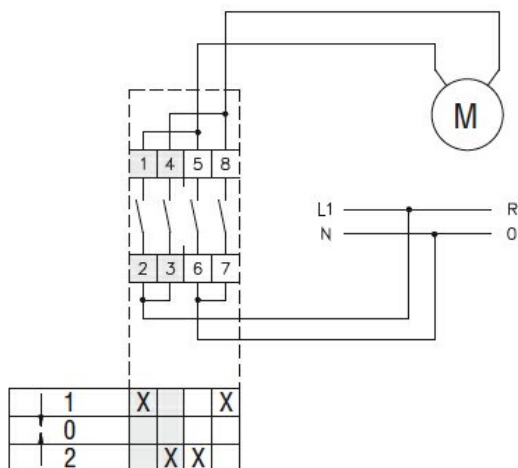

### Certifications and compliance

#### Compliance

CSA C22.2 n° 14  
IEC/EN/BS 60947-1  
IEC/EN/BS 60947-3  
IEC/EN/BS 60947-5-1  
UL60947-4-1

#### Certificates

cCSAus  
EAC  
UL

### ETIM classification

ETIM 8.0

EC001029 -  
Selector switch,  
complete