

Product designation				Rotary cam switches
Product type designation				7GN40
General characteristics				
Switching diagram				124 - Multi-step 0-1-2-3 2 poles
N° of elements				3
Mounting form				O - Rear mounting with black handle
Contact characteristics				
Rated insulation voltage Ui				
	IEC/EN	V	690	
	UL/CSA	V	600	
Rated impulse withstand voltage Uimp				kV 6
Conventional free air thermal current Ith				
	IEC/EN	A	40	
	UL/CSA	A	50	
Rated operational voltage				V 480
Rated operational impulse voltage				kV 4
Maximum fuse size for short-circuit protection In (gG)				
	10kA	A	40	
	15kA	A	40	
	25kA	A	40	
	50kA	A	40	
	63kA	A	40	
Rated short time current Icw				
	1s	kA	1000	
Conductivity				10/5 mA/V
Operational current Ie IEC/EN				
AC1/AC21A				
		A	40	
AC15				
	110V	A	25	
	220/230V	A	22	
	380/400V	A	12	
	660/690V	A	2	
Rated operational power in AC				
Three-phase AC-3				
	220/230V	kW	8	
	380/440V	kW	15	
	500/690V	kW	15	
Single-phase AC-3				
	110V	kW	3	
	220/230V	kW	6.5	
	380/440V	kW	8	
Three-phase AC23A				
	220/230V	kW	8	
	380/440V	kW	18.5	
	500/690V	kW	22	
Single-phase AC23A				
	110V	kW	3	
	220/230V	kW	6	

		380/440V	kW	11
Rated operational current in DC				
DC21A		48V	A	40
		60V	A	40
		110V	A	6
		220V	A	0.9
DC23A (poles in series)		24V	A	40 (1)
		48V	A	40 (2)
		60V	A	40 (3)
		110V	A	20 (3)
		220V	A	12 (4)
DC13		24V	A	40
		48V	A	32
		60V	A	16
		110V	A	3
Power dissipation			W	2.0
Mechanical features				
Terminals screw				M4
Tightening torque for terminals max			Nm	1.2
Conductor size				
AWG - Rigid cable		min	AWG	16
		Max	AWG	8
AWG - Flexible cable		min	AWG	16
		Max	AWG	10
Conductor size (IEC) - Flexible cable		min	mm <sup>2</sup>	1.5
		Max	mm <sup>2</sup>	6
Conductor size (IEC) - Rigid cable		min	mm <sup>2</sup>	1.5
		Max	mm <sup>2</sup>	10
Mechanical life			cycles	5x10 <sup>6</sup>
UL technical data				
Motor power for direct-on-line control				
for three-phase motor		120V	HP	5
		240V	HP	10
		480V	HP	20
		600V	HP	20
for single-phase motor		120V	HP	2
		240V	HP	5
Ambient conditions				
Temperature				
Operating temperature		min	°C	-25
		max	°C	+55
Storage temperature		min	°C	-40
		max	°C	+70

## Resistance & Protection

Frontal IP degree	IP40
Terminals IP degree	IP00

## Dimensions

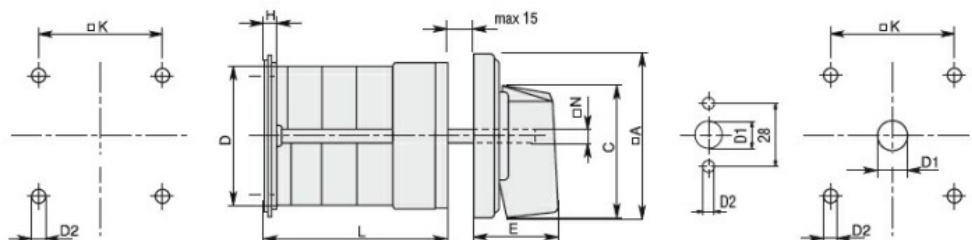

Series	Dimensions								L Number of elements											
	□A	C	ØD	ØD2	E	H	□K	□N	1	2	3	4	5	6	7	8	9	10	11	12
7GN12	48	39.5	39	5	26.5	5	36	6	38.1	47.8	57.5	67.2	76.9	86.6	96.3	106	115.7	125.4	135.1	144.8
7GN20	48	39.5	39	5	26.5	5	36	6	38.1	47.8	57.5	67.2	76.9	86.6	96.3	106	115.7	125.4	135.1	144.8
7GN25	48	39.5	43	5	26.5	5	36	6	42.5	56.1	69.7	83.3	96.9	110.5	124.1	137.7	151.3	164.9	178.5	192.1
7GN32	65	53	58	5	34.5	5.5	48	7	48.5	63.6	78.7	93.8	108.9	124	139.1	154.2	169.3	184.4	199.5	214.6
7GN40	65	53	58	5	34.5	5.5	48	7	48.5	63.6	78.7	93.8	108.9	124	139.1	154.2	169.3	184.4	199.5	214.6
7GN63	65	53	62	6	34.5	7.5	68	7	53.3	71.4	89.5	107.6	125.7	143.8	161.9	180	198.1	216.2	234.3	252.4
7GN125	90	70.5	86	6	41.4	7.5	68	9	74.8	103.9	133	162.1	191.2	220.3	249.4	278.5	307.6	336.7	365.8	394.9

## Wiring diagrams

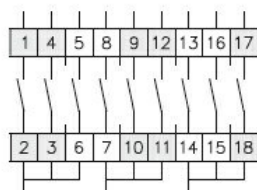

0																				
1	X					X		X												
2			X	X																X
3		X				X				X			X							

108 —  
124 —  
136 —

## Certifications and compliance

### Compliance

CSA C22.2 n° 14  
IEC/EN/BS 60947-1  
IEC/EN/BS 60947-3  
IEC/EN/BS 60947-5-1  
UL60947-4-1

### Certificates

cCSAus  
EAC  
UL

## ETIM classification

ETIM 8.0

EC001029 -  
Selector switch,  
complete