

Product designation			Enclosed rotary cam switch		
Product type designation			7GN20		
General characteristics					
Switching diagram			26 - 3-phase motor reversing switch with spring return		
N° of elements			3		
Mounting form			P25 - Plastic enclosure with red/yellow handle		
Contact characteristics					
Rated insulation voltage Ui			IEC/EN	V	690
			UL/CSA	V	600
Rated impulse withstand voltage Uimp				kV	6
Conventional free air thermal current Ith			IEC/EN	A	20
			UL/CSA	A	20
Rated operational voltage				V	480
Rated operational impulse voltage				kV	4
Maximum fuse size for short-circuit protection In (gG)			10kA	A	20
			15kA	A	16
			25kA	A	16
Rated short time current Icw			1s	kA	250
Conductivity			10/5 mA/V		
Operational current Ie IEC/EN					
AC1/AC21A				A	20
AC15			110V	A	10
			220/230V	A	8
			380/400V	A	6
			660/690V	A	1.5
Rated operational power in AC					
Three-phase AC-3			220/230V	kW	3
			380/440V	kW	5.5
			500/690V	kW	5.5
Single-phase AC-3			110V	kW	0.8
			220/230V	kW	2.2
			380/440V	kW	3
Three-phase AC23A			220/230V	kW	5
			380/440V	kW	7.5
			500/690V	kW	7.5
Single-phase AC23A			110V	kW	0.8
			220/230V	kW	2.5

		380/440V	kW	3.7
Rated operational current in DC				
DC21A				
		48V	A	20
		60V	A	20
		110V	A	4
		220V	A	0.6
		440V	A	0.25
DC23A (poles in series)				
		24V	A	20 (1)
		48V	A	20 (2)
		60V	A	20 (3)
		110V	A	10 (3)
		220V	A	8 (4)
DC13				
		24V	A	20
		48V	A	16
		60V	A	12
		110V	A	1
		220V	A	0.4
		440V	A	0.15
Power dissipation			W	0.8
Mechanical features				
Terminals screw				M3
Tightening torque for terminals max			Nm	0.5
Conductor size				
AWG - Rigid cable				
		min	AWG	20
		Max	AWG	12
AWG - Flexible cable				
		min	AWG	20
		Max	AWG	14
Conductor size (IEC) - Flexible cable				
		min	mm <sup>2</sup>	0.5
		Max	mm <sup>2</sup>	2.5
Conductor size (IEC) - Rigid cable				
		min	mm <sup>2</sup>	0.5
		Max	mm <sup>2</sup>	2.5
Mechanical life			cycles	5x10 <sup>6</sup>
UL technical data				
Motor power for direct-on-line control				
for three-phase motor				
		120V	HP	1.5
		240V	HP	3
		480V	HP	7.5
		600V	HP	10
for single-phase motor				
		120V	HP	0.75
		240V	HP	2
Ambient conditions				
Temperature				
Operating temperature				
		min	°C	-25
		max	°C	+55

Storage temperature

min °C -40  
max °C +70

### Resistance & Protection

Frontal IP degree IP65

Terminals IP degree IP00

### Dimensions

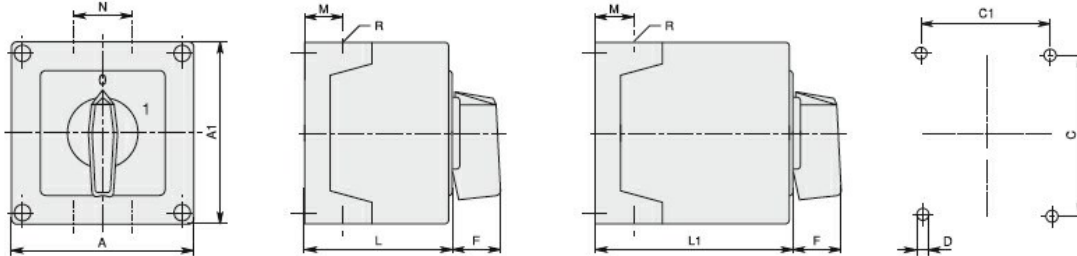

Series	Enclosure size	Number of elements		Dimensions										Cable entry	Protection degree
		L	L1	A	A1	C	C1	D	F	M	N	L	L1		
7GN12	75x75	1 - 2	3 - 4	75	75	50	64	4.5	19	14	28	57.5	79.8	4xPG13.5	IP65
7GN20		1 - 2	3 - 4												
7GN25		1	2 - 3												
7GN12	90x90	1 - 3	4 - 6	90	90	79	63	4.5	25	19	30	71.3	98.3	4xPG16	IP65
7GN20		1 - 3	4 - 6												
7GN25		1 - 2	3 - 4												
7GN32		1 - 2	3 - 4												
7GN40	110x110	1	2 - 3	110	110	98.4	83	4.5	32	21	39.5	85.5	119.5	4xPG21	IP65
7GN12		1 - 4	5 - 8												
7GN20		1 - 4	5 - 8												
7GN25		1 - 3	4 - 5												
7GN32		1 - 3	4 - 5												
7GN40	125x175	1 - 2	3 - 5	125	175	146	112	5.5	32	21	68	84.3	118.3	4xPG21 2xPG11	IP65
7GN63		1 - 2	3 - 4												
7GN125		1	2												
7GN32	180x254	1 - 3	4 - 5	180	254	120	190	5.5	32	35	76	121	175	4xPG29 2xPG11	IP65
7GN40		1 - 4	5 - 7												
7GN63		1 - 3	4 - 6												
7GN125		1 - 2	3 - 4												

### Wiring diagrams

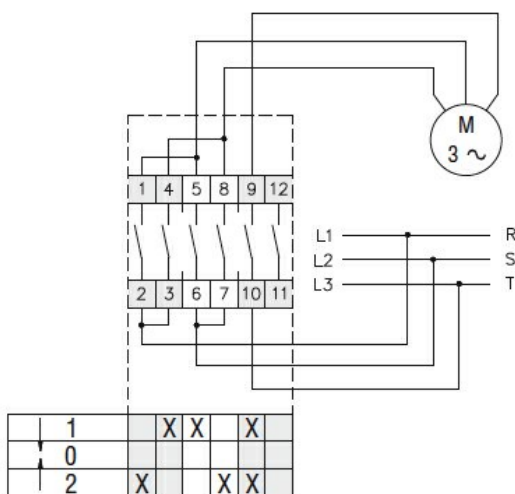

### Certifications and compliance

Compliance

IEC/EN/BS 60947-1

IEC/EN/BS 60947-3

ENCLOSED ROTARY CAM SWITCH 7GN SERIES, 3-PHASE MOTOR REVERSING SWITCH  
WITH SPRING RETURN 20A IN PLASTIC ENCLOSURE 90X90MM WITH RED/YELLOW  
HANDLE

---

IEC/EN/BS 60947-5-1

---

Certificates

EAC

ETIM classification

ETIM 8.0

EC001029 -  
Selector switch,  
complete