

Product designation			Rotary cam switches	
Product type designation			GX20	
General characteristics				
Switching diagram			110 - Multi-step 0-1-2-3-4-5 1 pole	
N° of elements			3	
Mounting form			U47 - Snap on fron mounting with black handle for hole diam. 22mm finxing	
Contact characteristics				
Rated insulation voltage Ui			IEC/EN UL/CSA	V V 690 600
Rated impulse withstand voltage Uimp			kV	6
Conventional free air thermal current Ith			IEC/EN UL/CSA	A A 20 15
Rated operational voltage			V	440
Rated operational impulse voltage			kV	4
Maximum fuse size for short-circuit protection In (gG)			10kA 15kA 25kA	A A A 20 20 20
Rated short time current Icw			1s	kA 250
Conductivity			10/5 mA/V	
Operational current Ie IEC/EN				
AC1/AC21A			A	20
AC15			110V 220/230V 380/400V 660/690V	A A A A 10 8 6 1.5
Rated operational power in AC				
Three-phase AC-3			220/230V 380/440V 500/690V	kW kW kW 3.7 5.5 5.5
Single-phase AC-3			110V 220/230V 380/440V	kW kW kW 0.75 1.8 3
Three-phase AC23A			220/230V 380/440V 500/690V	kW kW kW 4 7.5 7.5
Single-phase AC23A			110V	kW 0.75

		220/230V	kW	2.2
		380/440V	kW	3.5
Rated operational current in DC				
DC21A				
		48V	A	20
		60V	A	20
		110V	A	4
		220V	A	0.6
		440V	A	0.25
DC23A (poles in series)				
		24V	A	20 (1)
		48V	A	20 (2)
		60V	A	20 (3)
		110V	A	10 (3)
		220V	A	8 (4)
DC13				
		24V	A	20
		48V	A	16
		60V	A	12
		110V	A	1
		220V	A	0.4
		440V	A	0.15
Power dissipation			W	0.6
Mechanical features				
Terminals screw				M3
Tightening torque for terminals max			Nm	0.8
Conductor size				
AWG - Rigid cable				
		min	AWG	20
		Max	AWG	12
AWG - Flexible cable				
		min	AWG	20
		Max	AWG	12
Conductor size (IEC) - Flexible cable				
		min	mm ²	0.5
		Max	mm ²	2.5
Conductor size (IEC) - Rigid cable				
		min	mm ²	0.5
		Max	mm ²	2.5
Mechanical life			cycles	1X10 ⁶
UL technical data				
Motor power for direct-on-line control				
for three-phase motor				
		120V	HP	1.5
		240V	HP	3
		480V	HP	5
		600V	HP	5
for single-phase motor				
		120V	HP	0.75
		240V	HP	1.5
Ambient conditions				
Temperature				
Operating temperature				
		min	°C	-25

Storage temperature	max	°C	+55
	min	°C	-40
	max	°C	+70

Resistance & Protection

Frontal IP degree	IP65
Terminals IP degree	IP20

Dimensions

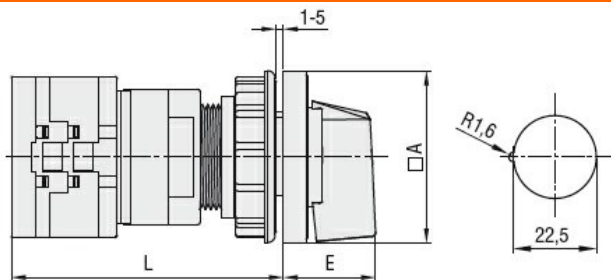

Series	Dimensions		L			
	□A	E	1	2	3...8	
GX16	48	26.5	64.9	73.4	81.9	124.4
GX20	48	26.5	64.9	73.4	81.9	124.4

Wiring diagrams

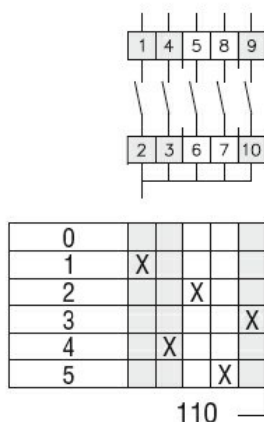

Certifications and compliance

Compliance

CSA C22.2 n° 14
IEC/EN/BS 60947-1
IEC/EN/BS 60947-3
IEC/EN/BS 60947-5-1
IEC/EN/BS 61058-1
UL60947-4-1

Certificates

cULus
EAC

ETIM classification

ETIM 8.0

EC001029 -
Selector switch,
complete