

Product designation			Rotary cam switches	
Product type designation			7GN25	
General characteristics				
Switching diagram			67 - Voltmeter switch for phase-phase voltages	
N° of elements			2	
Mounting form			U47 - Snap on fron mounting with black handle for hole diam. 22mm finxing	
Contact characteristics				
Rated insulation voltage Ui			IEC/EN UL/CSA	V V 690 600
Rated impulse withstand voltage Uimp			kV	6
Conventional free air thermal current Ith			IEC/EN UL/CSA	A A 25 30
Rated operational voltage			V	480
Rated operational impulse voltage			kV	4
Maximum fuse size for short-circuit protection In (gG)			10kA 15kA 25kA	A A A 25 25 25
Rated short time current Icw			1s	kA 400
Conductivity			10/5 mA/V	
Operational current Ie IEC/EN				
AC1/AC21A			A	25
AC15			110V 220/230V 380/400V 660/690V	A A A A 16 12 8 2
Rated operational power in AC				
Three-phase AC-3			220/230V 380/440V 500/690V	kW kW kW 5.5 7.5 7.5
Single-phase AC-3			110V 220/230V 380/440V	kW kW kW 1.5 3 5.5
Three-phase AC23A			220/230V 380/440V 500/690V	kW kW kW 6.5 11 11
Single-phase AC23A			110V	kW 1.5

		220/230V	kW	3.7
		380/440V	kW	5.5
Rated operational current in DC				
DC21A				
		48V	A	25
		60V	A	25
		110V	A	4
		220V	A	0.7
DC23A (poles in series)				
		24V	A	25 (1)
		48V	A	25 (2)
		60V	A	25 (3)
		110V	A	12 (3)
		220V	A	10 (4)
DC13				
		24V	A	25
		48V	A	20
		60V	A	16
		110V	A	1.5
		220V	A	0.4
Power dissipation			W	1.1
Mechanical features				
Terminals screw				M3.5
Tightening torque for terminals max			Nm	0.8
Conductor size				
AWG - Rigid cable				
	min	AWG		20
	Max	AWG		10
AWG - Flexible cable				
	min	AWG		20
	Max	AWG		12
Conductor size (IEC) - Flexible cable				
	min	mm ²		0.5
	Max	mm ²		4
Conductor size (IEC) - Rigid cable				
	min	mm ²		0.5
	Max	mm ²		4
Mechanical life			cycles	5x10 ⁶
UL technical data				
Motor power for direct-on-line control				
for three-phase motor				
	120V	HP		3
	240V	HP		5
	480V	HP		10
	600V	HP		15
for single-phase motor				
	120V	HP		1.5
	240V	HP		3
Ambient conditions				
Temperature				
Operating temperature				
	min	°C		-25
	max	°C		+55
Storage temperature				

min	°C	-40
max	°C	+70

Resistance & Protection

Frontal IP degree	IP40
Terminals IP degree	IP00

Dimensions

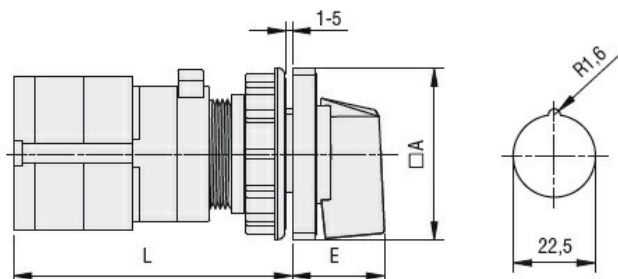

Series	Dimensions		L			
	□A	E	1	2	3....8	
7GN12	48	26.5	58	67.7	77.4	125.9
7GN20	48	26.5	58	67.7	77.4	125.9
7GN25	48	26.5	62.4	76	89.6	157.6

Wiring diagrams

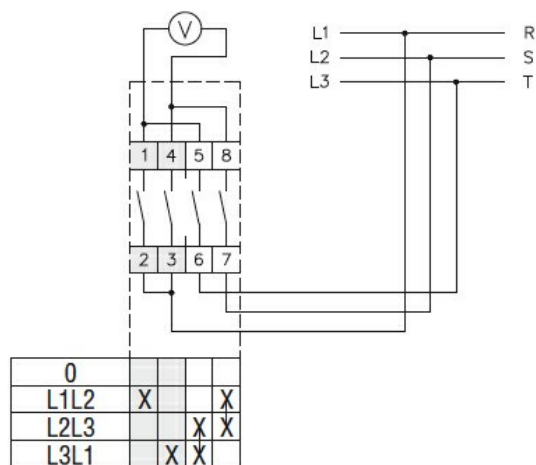

Certifications and compliance

Compliance

CSA C22.2 n° 14
IEC/EN/BS 60947-1
IEC/EN/BS 60947-3
IEC/EN/BS 60947-5-1
UL60947-4-1

Certificates

cCSAus
EAC
UL

ETIM classification

ETIM 8.0

EC001029 -
Selector switch,
complete