

| | | | |
|--|--|------------------|---------------------|
| Product designation | Rotary cam switches | | |
| Product type designation | 7GN20 | | |
| General characteristics | | | |
| Switching diagram | 06 - ON/OFF switch 2 poles | | |
| N° of elements | 1 | | |
| Mounting form | U25 - Front mounting with red/yellow handle padlockable in 0 and protection covers | | |
| Contact characteristics | | | |
| Rated insulation voltage Ui | IEC/EN UL/CSA | V V | 690 600 |
| Rated impulse withstand voltage Uimp | | kV | 6 |
| Conventional free air thermal current Ith | IEC/EN UL/CSA | A A | 20 20 |
| Rated operational voltage | | V | 480 |
| Rated operational impulse voltage | | kV | 4 |
| Maximum fuse size for short-circuit protection In (gG) | 10kA 15kA 25kA | A A A | 20 16 16 |
| Rated short time current Icw | 1s | kA | 250 |
| Conductivity | 10/5 mA/V | | |
| Operational current Ie IEC/EN | | | |
| AC1/AC21A | | A | 20 |
| AC15 | 110V 220/230V 380/400V 660/690V | A A A A | 10 8 6 1.5 |
| Rated operational power in AC | | | |
| Three-phase AC-3 | 220/230V 380/440V 500/690V | kW kW kW | 3 5.5 5.5 |
| Single-phase AC-3 | 110V 220/230V 380/440V | kW kW kW | 0.8 2.2 3 |
| Three-phase AC23A | 220/230V 380/440V 500/690V | kW kW kW | 5 7.5 7.5 |
| Single-phase AC23A | 110V | kW | 0.8 |

| | | | | |
|--|--|----------|-----------------|-------------------|
| | | 220/230V | kW | 2.5 |
| | | 380/440V | kW | 3.7 |
| Rated operational current in DC | | | | |
| DC21A | | | | |
| | | 48V | A | 20 |
| | | 60V | A | 20 |
| | | 110V | A | 4 |
| | | 220V | A | 0.6 |
| | | 440V | A | 0.25 |
| DC23A (poles in series) | | | | |
| | | 24V | A | 20 (1) |
| | | 48V | A | 20 (2) |
| | | 60V | A | 20 (3) |
| | | 110V | A | 10 (3) |
| | | 220V | A | 8 (4) |
| DC13 | | | | |
| | | 24V | A | 20 |
| | | 48V | A | 16 |
| | | 60V | A | 12 |
| | | 110V | A | 1 |
| | | 220V | A | 0.4 |
| | | 440V | A | 0.15 |
| Power dissipation | | | W | 0.8 |
| Mechanical features | | | | |
| Terminals screw | | | | M3 |
| Tightening torque for terminals max | | | Nm | 0.5 |
| Conductor size | | | | |
| AWG - Rigid cable | | | | |
| | | min | AWG | 20 |
| | | Max | AWG | 12 |
| AWG - Flexible cable | | | | |
| | | min | AWG | 20 |
| | | Max | AWG | 14 |
| Conductor size (IEC) - Flexible cable | | | | |
| | | min | mm ² | 0.5 |
| | | Max | mm ² | 2.5 |
| Conductor size (IEC) - Rigid cable | | | | |
| | | min | mm ² | 0.5 |
| | | Max | mm ² | 2.5 |
| Mechanical life | | | cycles | 5x10 ⁶ |
| UL technical data | | | | |
| Motor power for direct-on-line control | | | | |
| for three-phase motor | | | | |
| | | 120V | HP | 1.5 |
| | | 240V | HP | 3 |
| | | 480V | HP | 7.5 |
| | | 600V | HP | 10 |
| for single-phase motor | | | | |
| | | 120V | HP | 0.75 |
| | | 240V | HP | 2 |
| Ambient conditions | | | | |
| Temperature | | | | |
| Operating temperature | | | | |
| | | min | °C | -25 |

| | | | |
|---------------------|-----|----|-----|
| | max | °C | +55 |
| Storage temperature | min | °C | -40 |
| | max | °C | +70 |

Resistance & Protection

| | |
|---------------------|------|
| Frontal IP degree | IP40 |
| Terminals IP degree | IP00 |

Dimensions

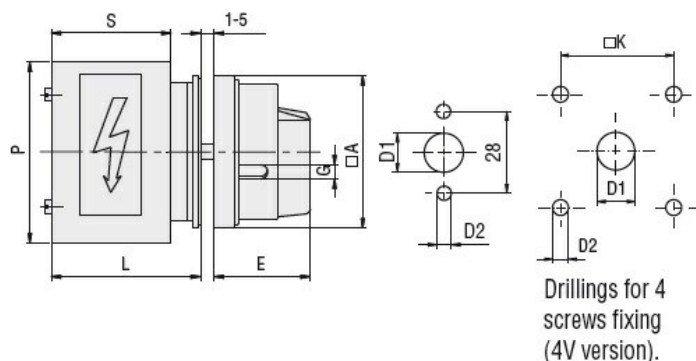

| Series | Dimensions | | | | | | | | |
|--------|------------|----|----|------|---|----|----|----|------|
| | □A | D1 | D2 | E | G | □K | S | P | L |
| 7GN12 | 65 | 12 | 5 | 34.2 | 5 | 36 | 43 | 64 | 54.3 |
| 7GN20 | 65 | 12 | 5 | 34.2 | 5 | 36 | 43 | 64 | 54.3 |
| 7GN25 | 65 | 12 | 5 | 34.2 | 5 | 36 | 51 | 68 | 62.6 |
| 7GN32 | 65 | 14 | 5 | 38 | 6 | 48 | 55 | 77 | 71.7 |
| 7GN40 | 65 | 14 | 5 | 38 | 6 | 48 | 55 | 77 | 71.7 |

Wiring diagrams

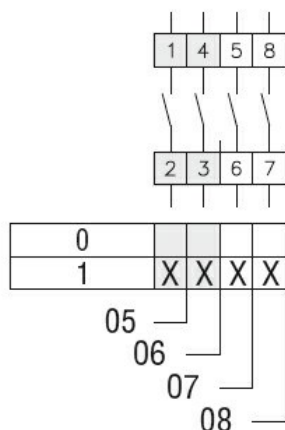

Certifications and compliance

Compliance

CSA C22.2 n° 14
IEC/EN/BS 60947-1
IEC/EN/BS 60947-3
IEC/EN/BS 60947-5-1
UL60947-4-1

Certificates

cCSAus
EAC
UL

ETIM classification

ETIM 8.0

EC001105 - Off-
load switch