

Product designation				Enclosed rotary cam switch
Product type designation				7GN12
General characteristics				
Switching diagram				90 - ON/OFF switch 1 pole
N° of elements				1
Mounting form				P25 - Plastic enclosure with red/yellow handle
Contact characteristics				
Rated insulation voltage Ui				
	IEC/EN	V	690	
	UL/CSA	V	600	
Rated impulse withstand voltage Uimp				kV 6
Conventional free air thermal current Ith				
	IEC/EN	A	16	
	UL/CSA	A	15	
Rated operational voltage				V 480
Rated operational impulse voltage				kV 4
Maximum fuse size for short-circuit protection In (gG)				
	10kA	A	16	
	15kA	A	10	
	25kA	A	10	
Rated short time current Icw				
	1 s	kA	200	
Conductivity				10/5 mA/V
Operational current Ie IEC/EN				
AC1/AC21A				A 16
AC15				
	110V	A	10	
	220/230V	A	8	
	380/400V	A	4	
	660/690V	A	1.5	
Rated operational power in AC				
Three-phase AC-3				
	220/230V	kW	2.5	
	380/440V	kW	4	
	500/690V	kW	5.5	
Single-phase AC-3				
	110V	kW	0.8	
	220/230V	kW	1.5	
	380/440V	kW	2.2	
Three-phase AC23A				
	220/230V	kW	3	
	380/440V	kW	5.5	
	500/690V	kW	7.5	
Single-phase AC23A				
	110V	kW	0.8	
	220/230V	kW	1.7	
	380/440V	kW	3	
Rated operational current in DC				

### DC21A

48V	A	12
60V	A	12
110V	A	4
220V	A	0.6
440V	A	0.25

### DC23A (poles in series)

24V	A	10 (1)
48V	A	10 (2)
60V	A	10 (3)
110V	A	5 (3)
220V	A	5 (4)

### DC13

24V	A	12
48V	A	10
60V	A	8
110V	A	1
220V	A	0.4
440V	A	0.15

Power dissipation	W	0.8
-------------------	---	-----

### Mechanical features

Terminals screw	M3
-----------------	----

Tightening torque for terminals max	Nm	0.5
-------------------------------------	----	-----

### Conductor size

#### AWG - Rigid cable

min	AWG	20
Max	AWG	12

#### AWG - Flexible cable

min	AWG	20
Max	AWG	14

#### Conductor size (IEC) - Flexible cable

min	mm <sup>2</sup>	0.5
Max	mm <sup>2</sup>	2.5

#### Conductor size (IEC) - Rigid cable

min	mm <sup>2</sup>	0.5
Max	mm <sup>2</sup>	2.5

Mechanical life	cycles	3x10 <sup>6</sup>
-----------------	--------	-------------------

### UL technical data

#### Motor power for direct-on-line control

##### for three-phase motor

120V	HP	1.5
240V	HP	3

##### for single-phase motor

120V	HP	0.5
240V	HP	1

### Ambient conditions

#### Temperature

##### Operating temperature

min	°C	-25
max	°C	+55

##### Storage temperature

min	°C	-40
max	°C	+70

### Resistance & Protection

Frontal IP degree

IP65

Terminals IP degree

IP00

## Dimensions

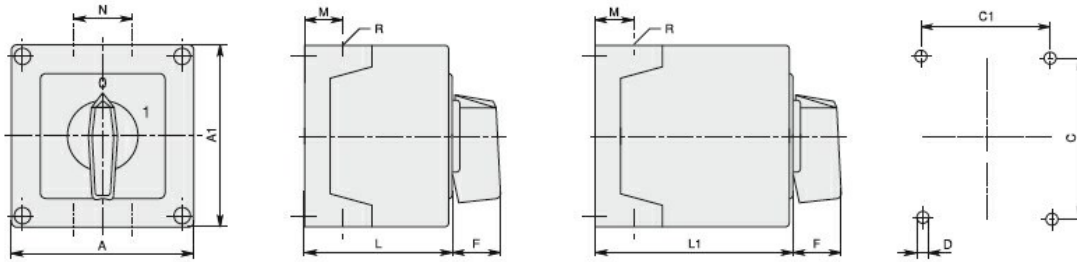

Series	Enclosure size	Number of elements		Dimensions										Cable entry	Protection degree
		L	L1	A	A1	C	C1	D	F	M	N	L	L1		
7GN12	75x75	1 - 2	3 - 4	75	75	50	64	4.5	19	14	28	57.5	79.8	4xPG13.5	IP65
7GN20		1 - 2	3 - 4												
7GN25		1	2 - 3												
7GN12	90x90	1 - 3	4 - 6	90	90	79	63	4.5	25	19	30	71.3	98.3	4xPG16	IP65
7GN20		1 - 3	4 - 6												
7GN25		1 - 2	3 - 4												
7GN32		1 - 2	3 - 4												
7GN40		1	2 - 3												
7GN12	110x110	1 - 4	5 - 8	110	110	98.4	83	4.5	32	21	39.5	85.5	119.5	4xPG21	IP65
7GN20		1 - 4	5 - 8												
7GN25		1 - 3	4 - 5												
7GN32		1 - 3	4 - 5												
7GN40		1 - 2	3 - 5												
7GN63		1 - 2	3 - 4												
7GN32	125x175	1 - 3	4 - 5	125	175	146	112	5.5	32	21	68	84.3	118.3	4xPG21 2xPG11	IP65
7GN40		1 - 2	3 - 4												
7GN63		1 - 2	3 - 4												
7GN125		1	2												
7GN32	180x254	1 - 5	6 - 8	180	254	120	190	5.5	32	35	76	121	175	4xPG29 2xPG11	IP65
7GN40		1 - 4	5 - 7												
7GN63		1 - 3	4 - 6												
7GN125		1 - 2	3 - 4												

## Wiring diagrams

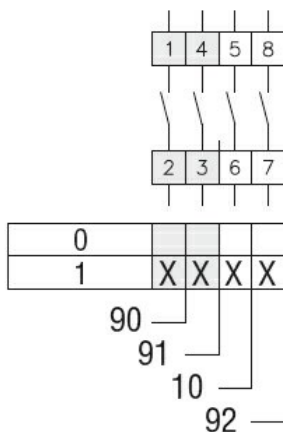

## Certifications and compliance

Compliance

IEC/EN/BS 60947-1

IEC/EN/BS 60947-3

IEC/EN/BS 60947-5-1

Certificates

EAC

## ETIM classification

ETIM 8.0

EC001029 -  
Selector switch,  
complete