

Product designation	Rotary cam switches		
Product type designation	7GN40		
<b>General characteristics</b>			
Switching diagram	75 - Changeover switch 4 poles		
N° of elements	4		
Mounting form	P - Plastic enclosure with black handle		
<b>Contact characteristics</b>			
Rated insulation voltage $U_i$	IEC/EN	V	690
	UL/CSA	V	600
Rated impulse withstand voltage $U_{imp}$		kV	6
Conventional free air thermal current $I_{th}$	IEC/EN	A	40
	UL/CSA	A	50
Rated operational voltage		V	480
Rated operational impulse voltage		kV	4
Maximum fuse size for short-circuit protection $I_n$ (gG)	10kA	A	40
	15kA	A	40
	25kA	A	40
	50kA	A	40
	63kA	A	40
Rated short time current $I_{cw}$	1s	kA	1000
	60s	A	1000
Conductivity	10/5 mA/V		
Operational current $I_e$ IEC/EN			
AC1/AC21A		A	40
AC15	110V	A	25
	220/230V	A	22
	380/400V	A	12
	660/690V	A	2
Rated operational power in AC			
Three-phase AC-3	220/230V	kW	8
	380/440V	kW	15
	500/690V	kW	15
Single-phase AC-3	110V	kW	3
	220/230V	kW	6.5
	380/440V	kW	8
Three-phase AC23A	220/230V	kW	8
	380/440V	kW	18.5
	500/690V	kW	22
Single-phase AC23A	110V	kW	3

		220/230V	kW	6
		380/440V	kW	11
<b>Rated operational current in DC</b>				
DC21A				
		48V	A	40
		60V	A	40
		110V	A	6
		220V	A	0.9
<b>DC23A (poles in series)</b>				
		24V	A	40 (1)
		48V	A	40 (2)
		60V	A	40 (3)
		110V	A	20 (3)
		220V	A	12 (4)
<b>DC13</b>				
		24V	A	40
		48V	A	32
		60V	A	16
		110V	A	3
<b>Power dissipation</b>			W	2.0
<b>Mechanical features</b>				
<b>Terminals screw</b>				M4
<b>Tightening torque for terminals max</b>			Nm	1.2
<b>Conductor size</b>				
AWG - Rigid cable				
		min	AWG	16
		Max	AWG	8
AWG - Flexible cable				
		min	AWG	16
		Max	AWG	10
Conductor size (IEC) - Flexible cable				
		min	mm <sup>2</sup>	1.5
		Max	mm <sup>2</sup>	6
Conductor size (IEC) - Rigid cable				
		min	mm <sup>2</sup>	1.5
		Max	mm <sup>2</sup>	10
<b>Mechanical life</b>			cycles	5x10 <sup>6</sup>
<b>UL technical data</b>				
<b>Motor power for direct-on-line control</b>				
for three-phase motor				
		120V	HP	5
		240V	HP	10
		480V	HP	20
		600V	HP	20
for single-phase motor				
		120V	HP	2
		240V	HP	5
<b>Ambient conditions</b>				
<b>Temperature</b>				
Operating temperature				
		min	°C	-25
		max	°C	+55
Storage temperature				
		min	°C	-40

max °C +70

**Resistance & Protection**

Frontal IP degree	IP65
Terminals IP degree	IP00

**Dimensions**

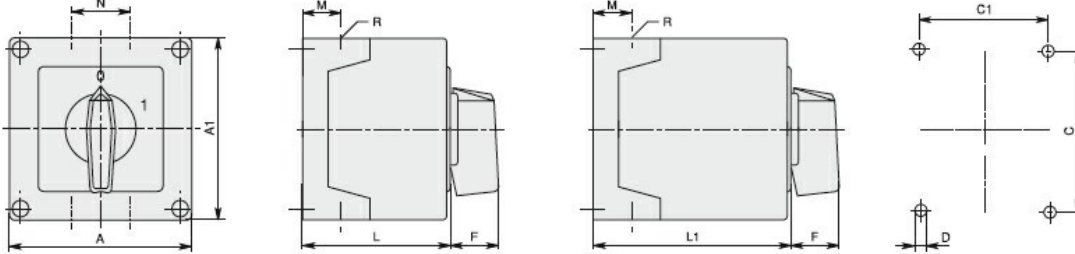

Series	Enclosure size	Number of elements		Dimensions										Cable entry	Protection degree
		L	L1	A	A1	C	C1	D	F	M	N	L	L1		
7GN12	75x75	1-2	3-4	75	75	50	64	4.5	19	14	28	57.5	79.8	4xPG13.5	IP65
7GN20		1-2	3-4												
7GN25		1	2-3												
7GN12	90x90	1-3	4-6	90	90	79	63	4.5	25	19	30	71.3	98.3	4xPG16	IP65
7GN20		1-3	4-6												
7GN25		1-2	3-4												
7GN32		1-2	3-4												
7GN40		1	2-3												
7GN12	110x110	1-4	5-8	110	110	98.4	83	4.5	32	21	39.5	85.5	119.5	4xPG21	IP65
7GN20		1-4	5-8												
7GN25		1-3	4-5												
7GN32		1-3	4-5												
7GN40		1-2	3-5												
7GN63		1-2	3-4												
7GN32	125x175	1-3	4-5	125	175	146	112	5.5	32	21	68	84.3	118.3	4xPG21 2xPG11	IP65
7GN40		1-2	3-4												
7GN63		1-2	3-4												
7GN125		1	2												
7GN32	180x254	1-5	6-8	180	254	120	190	5.5	32	35	76	121	175	4xPG29 2xPG11	IP65
7GN40		1-4	5-7												
7GN63		1-3	4-6												
7GN125		1-2	3-4												

**Wiring diagrams**

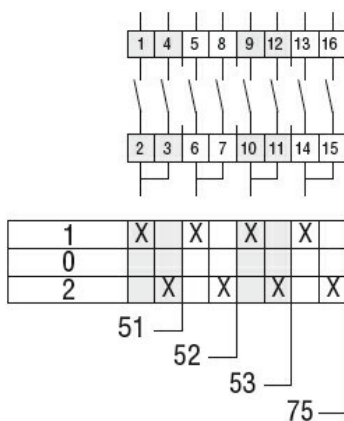

**Certifications and compliance**

**Compliance**

IEC/EN/BS 60947-1  
IEC/EN/BS 60947-3  
IEC/EN/BS 60947-5-1

**Certificates**

EAC

**ETIM classification**

ETIM 8.0

EC001105 - Off-  
load switch