



Type KFW/D



Product information

The KFW bulkhead fittings are made of specially modified polyamide 6. The material is self-extinguishing, and halogen, phosphor and cadmium-free. With the KFW/D and KFW/X bulkhead fittings, the cable protection conduits EW with standard corrugation and EWX with high corrugation can be directly mounted. The KFW bulkhead fittings feature the following advantages:

- System divided in two for very quick and easy installation of cables
- Subsequent installation of cables is simplified by the removable upper part
- Gasket included in delivery
- No extra fittings are required

Information, conformities and approvals

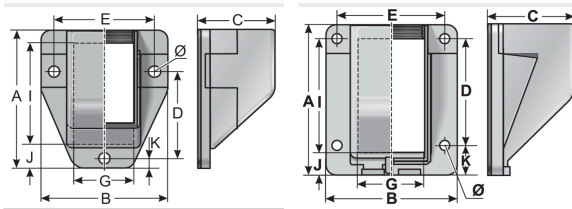

Article	Order No.	Color	UV	Suitable for Murrflex	A mm	B mm	C mm	D mm	E mm	G mm	I mm	J mm	K mm	Ø mm	PU pcs.
KFW/D 11	83561850	Black	✓	M16/P11	49	47	35	29	37	22.5	27	11	4.5	4.3	10
KFW/D 16	83561852	Black	✓	M20/P16(S)	49	47	35	29	37	22.5	27	11	4.5	4.3	10
KFW/D 21	83561854	Black	✓	M25/P21(S)	69	65	44	41.5	51.5	30	42.5	15	6	6	10
KFW/D 29	83561856	Black	✓	M32/P29(S)	90	78	55	64.5	64.5	40	68	9	16	6.5	10
KFW/D 36	83561858	Black	✓	M40/P36(S)	99	94	66	79.5	79.5	48.5	74.5	9.5	10	6.5	10
KFW/D 48	83561860	Black	✓	M50/P48(S)	116	101	76	87.5	87.5	68.5	89.5	9.5	16	6.5	10
KFW/D 11	83561810	Gray	✗	M16/P11	49	47	35	29	37	22.5	27	11	4.5	4.3	10
KFW/D 16	83561812	Gray	✗	M20/P16(S)	49	47	35	29	37	22.5	27	11	4.5	4.3	10
KFW/D 21	83561814	Gray	✗	M25/P21(S)	69	65	44	41.5	51.5	30	42.5	15	6	6	10
KFW/D 29	83561816	Gray	✗	M32/P29(S)	90	78	55	64.5	64.5	40	68	9	16	6.5	10
KFW/D 36	83561818	Gray	✗	M40/P36(S)	99	94	66	79.5	79.5	48.5	74.5	9.5	10	6.5	10
KFW/D 48	83561820	Gray	✗	M50/P48(S)	116	101	76	87.5	87.5	68.5	89.5	9.5	16	6.5	10



Type KFW/D

Material properties



mod. polyamide PA 6 || Neoprene (CR) ||

Thermal properties



Temperature / temperature range -40 °C – 110 °C / short term: 140 °C

Protection class



Protection class IP54

Fire properties



Fire classification acc. to UL94: V0 self-extinguishing



Fire properties as per EN 45545-2 C.I.T. R22 / R23 HL3 : 0,58 NF X 70-100-1/-2 600°C (1112 °F) LOI R22 / R23 HL3 : ≥ 32 % ISO 4589-2Ds (max.) R22 / R23 HL3 : 57 ISO 5659-2 (25 kW/m²)



Fire properties as per NFPA ASTM E 162 ASTM E 1354 ASTM E 662 Boeing BSS 7239 Boeing BSS 7242 Bombardier SMP 800-C

Chemical resistances



Resistant to: Alcohol Greases Fuels Mineral oils

Technical information



Halogen-free

Conformity



RoHS (EC Directive 2011/65/EU)

Approvals and operating permits



EU railway approval



cURus approval



Type KFW/D

Classification



ETIM 9: EC001176 || eClass 14: 27430312 || UNSPSC: 40183103 ||

General information



Made in Germany
